

1. order double wall stove pipe
2. order window

double-wall stove pipe

DL42-A \$95.35

DL12 - 24.10/ft

66 } \$240.00

talk to Ron

Michael—

15 Oct.

John -

please attach this
sticker to an inconspicuous
place on the new propane
refrigerator.

For the wilderness, this place gets lots of sonic booms.

OP ~~20~~ OUT 91

Jess,

Here are the measurements you requested:

lab building:

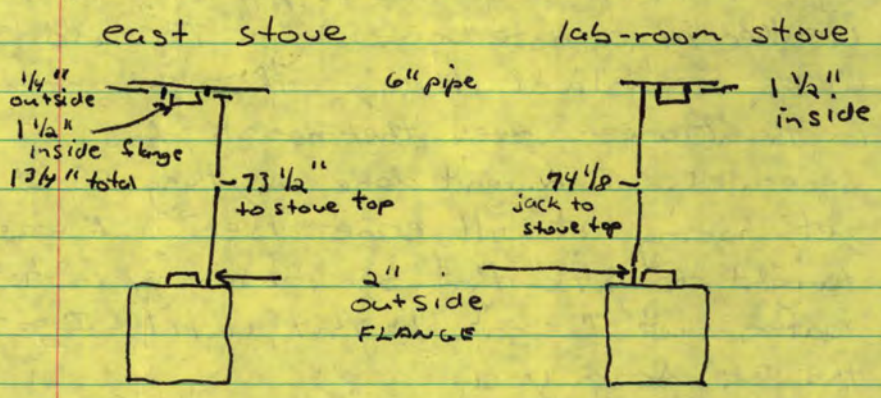

SE Window
inside frame
dimensions. I'm
surprised to find it
square.

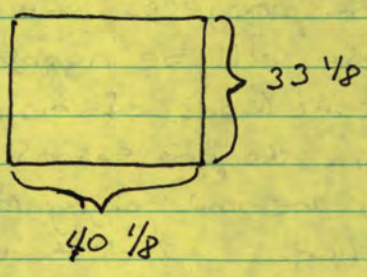

Cook house

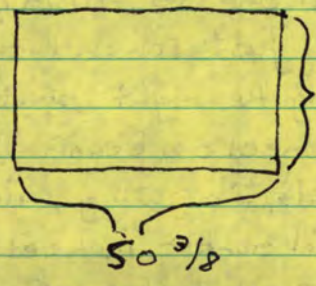

IS you are interested in a more uniform appearance or a cheaper, standardized window (and also room to put the frig in the corner), other cabin windows

inside dimensions,
current opening

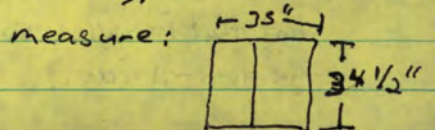

When I went to record the weather, I realized (pretty slow here) that I had used up the book. When I went to find a book, I only found full books. It also occurred to me that I was recording October in a book which should have been just for September. I still haven't found any blank books, in the lab building or house, though I'm probably looking right at them. So I am temporarily keeping weather in a note book. To add woes, I noticed today that the mercury in the Pioneer creek thermometer has seperated. I haven't done anything about it yet, hoping it will cure itself. I was taught to fix that by immersion in hot water, but I won't do that until I get the OK from you.

The projects are coming along. Your wife will be happy to know I added more cart loads of manure to her gardens, and am in the process of spading them under. Her bulbs are now hanging in an onion sack in your cellar. I do have a few questions:

- 1) Clipping Pathways (self explanatory) - do you want the path along Pioneer creek between the iron gate and the spring box clipped, or are you wanting that one to fill in?
- 2) Oiling cabin logs - just some clarification to make sure I'm using the right product
- 3) Are these chimneys in need of cleaning? (I guess I should just look myself, I'm getting paid)
- 4) The forest service trail marker installed in the bushes SE of the Big Creek bridge - Do you want that installed somewhere useful, or is the bushes the general idea? That's all for now.

John